

## User Guide

This document includes important information to ensure safe usage of the Morse type S. Before using the Morse type S, please read through this instruction guide and the enclosed "Safety Instructions" carefully. If anything is unclear, please contact us for more detailed instructions.



## Contents

Packaged Items	-----	1
Features	-----	2
How to connect	-----	2
Basic Usage	-----	3
Specifications	-----	3

## ■ Packaged Items

Before using the Morse, please verify that all the necessary items are included. If you find any part missing, defective, or damaged, please contact us.



Morse Type S



Video Cable



AC Adaptor

# Features

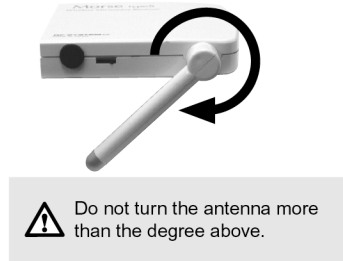
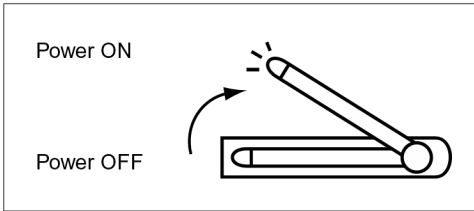
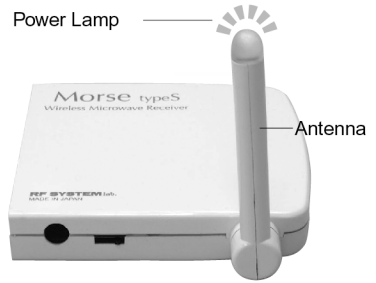
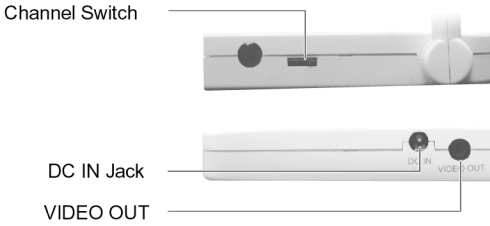

# How to connect

- 1 Select an external input channel on your TV.
- 2 Connect the AC adapter to Morse type S (DC IN), and o the AC outlet
- 3 Connect the thin end of the Video Cable to Morse type S (VIDEO OUT Jack), and the thick end to the yellow colored Video Input Jack of your TV.
- 4 Turn the antenna upright. The Power Lamp lights in blue to confirm the power is on.

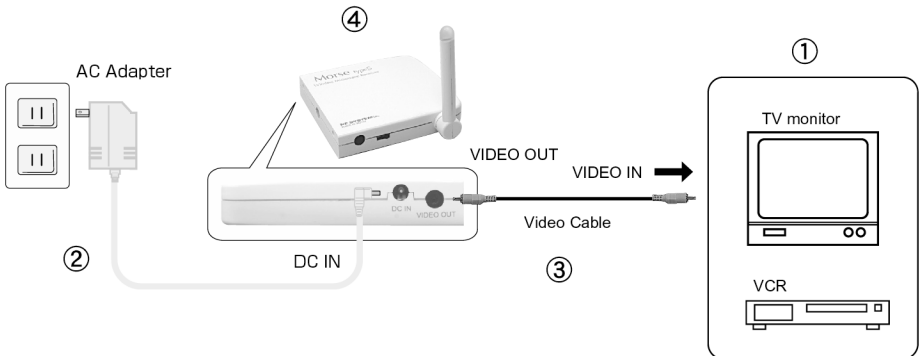

## Basic Usage

Adjust the channel setting in correspondence with the camera/ transmitter channel.

### ●Channel Switch

See below to adjust the channel setting.

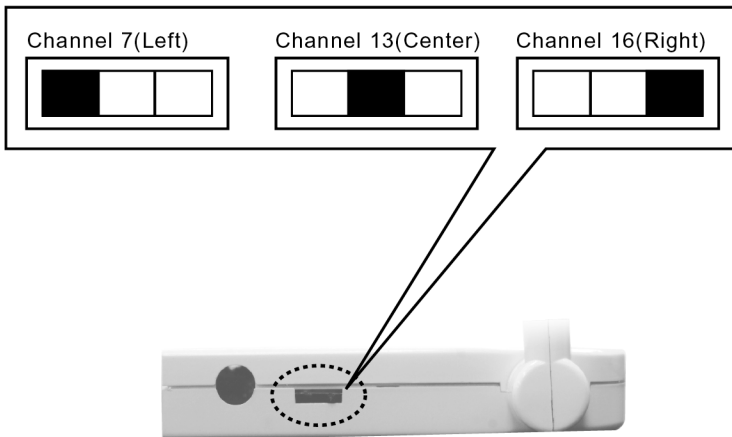

## Specification

- Reception Frequency 2.4GHz range
- Reception Sensitivity -70dBm
- Power Supply 6V approx. 270mA
- Video Output \*The unit can be connected with generic household TVs/VCRs/Video Capture Cards
- Weight Approx. 40g 1.41oz

Inspired by dreams.  
**RF SYSTEM** lab.